

SIXTIETH ANNUAL MEETING
SOUTHEASTERN DIVISION
OF THE ASSOCIATION OF
AMERICAN GEOGRAPHERS
(SEDAAG)

Web sites for further information:

SEDAAG home page: <http://www.sedaag.org/>

Local Arrangements: <http://www.geosciences.fau.edu/SEDAAG2005.htm>

Program Committee: <http://people.cas.sc.edu/ajames/SEDAAG/05/>

Paper and poster abstracts are listed on the Program Committee site.

Reminder to speakers:

If using a digital projector, please bring your file to the room at least ten minutes prior to the beginning of your session. Someone should be there to help you upload it onto the PC. If not, proceed to upload your file so it will be ready to go at the allotted time.

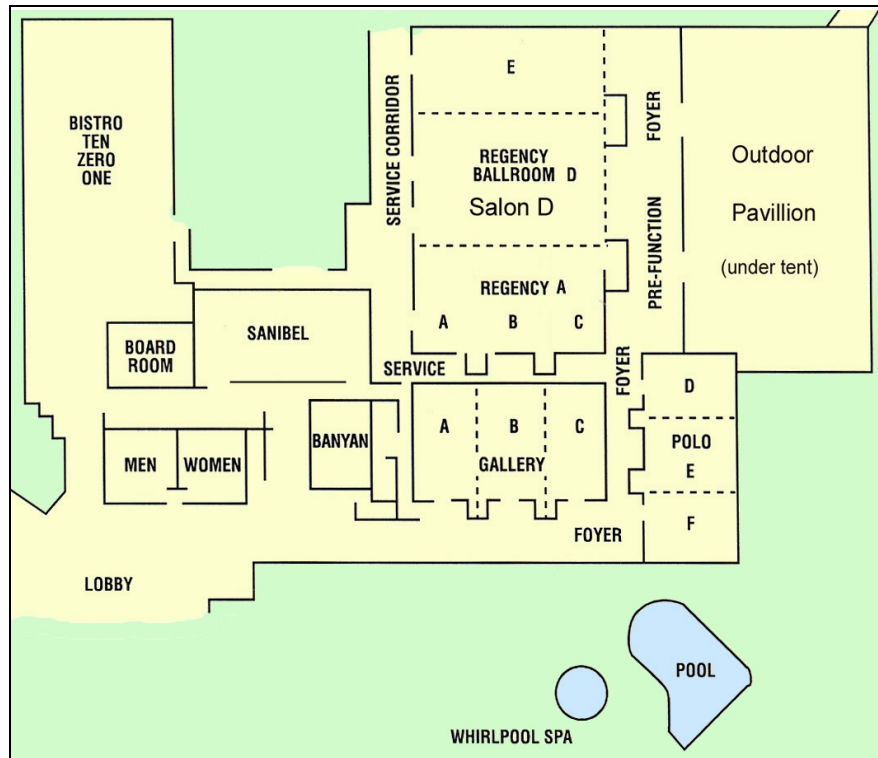

PROGRAM
WEST PALM BEACH, FLORIDA
NOVEMBER 20-22, 2005



Notes:

SEDAAG EXECUTIVE COMMITTEE

President: **Stephen J. Walsh**, UNC at Chapel Hill
Vice President: **Clifton ‘Skeeter’ Dixon**, University of
Southern Mississippi
Treasurer: **Altha Cravey**, UNC at Chapel Hill
Secretary: **Douglas W. Gamble**, UNC at Wilmington
Councillor: **Tyrel G. Moore**, UNC at Charlotte
Past President: **Ronald L. Mitchelson**, East Carolina Univ.

SEDAAG STEERING COMMITTEE

Members of the Executive Committee (see above) plus these:

Editors, Southeastern Geographer, **Derek H. Alderman** and

Scott A. Lecce, East Carolina University

Alabama: **Kelly Gregg**, Jacksonville State University

Florida: **Sharon Cobb**, University of North Florida

Georgia: **Angela Yao**, University of Georgia

Kentucky: **Alice Turkington**, University of Kentucky

Mississippi: **Jerry Griffith**, Univ. of Southern Mississippi

North Carolina: **Jamie Strickland**, UNC at Charlotte

South Carolina: **Carl Dahlman**, University of South Carolina

Tennessee: **Evan Hart**, Tennessee Technical University

Virginia: **Michael Harrison**, University of Richmond

West Virginia: **Brent McCusker**, West Virginia University

World Geography Bowl Sponsors:

SEDAAG Local Arrangements

Committee

Russell Ivy, Chair, Florida Atlantic University

Charles Roberts, **Jackie Gallagher**, **Maria Fadiman**, **Liem**

Tran, and **Bill O’Brien**, Florida Atlantic University, and

Mary Caravelis, Barry University

Host Institution: Florida Atlantic University

Session 30 – Culture and Landscapes

Tuesday 8:00 am - 10:00 am - Polo F

Chair: **Stephen Birdsall**

Stephen S. Birdsall. UNC at Chapel Hill - *Collective Memory and Memorial Landscapes: Scenes from America's High Plains*.

Discussant: **Skeeter Dixon**, Univ. Southern Mississippi.

Thomas L. Bell. Univ. Tennessee - *Place and Popular Culture in Selected Works of Playwright Neil LaBute*. Discussant: **Skeeter Dixon**, Univ. Southern Mississippi.

Joseph Palis. UNC at Chapel Hill - *Filming The National: Identity and Nationhood in Two Filipino Films*. Discussant: **Thomas L. Bell**. Univ. Tennessee.

Sara Beth Keough. Univ. Tennessee - *Definitions of Local Culture in Community Radio Broadcasts: An Ethnographic Case Study of WDVX, Knoxville, Tennessee*. Discussant: **Billy Terry**, Univ. South Carolina.

Daniel McGowin. Univ. Alabama - *Geographic Bias on ESPN's SportsCenter and its Influence on Major Leagues All-Star Voting*. Discussant: **Stephen S. Birdsall**. UNC at Chapel Hill.

BUSINESS MEETING

10:15 am - 12:15 pm Sanibel 1 & 2

Stephen J. Walsh, Presiding, President, SEDAAG, University of North Carolina at Chapel Hill.

Address by **Doug Richardson**, Executive Director of AAG.

Adjournment

Have a safe journey home !!!

SEDAAG PROGRAM COMMITTEE

Co-chairs: **Clifton 'Skeeter' Dixon**, Univ. Southern Mississippi, **Allan James**, Univ. South Carolina, and **Ron Mitchelson**, East Carolina Univ.

Members (Due to Hurricane Katrina, the SEDAAG Executive Committee served as the Program Committee this year):

Altha Cravey, UNC at Chapel Hill, **Doug Gamble**, UNC at Wilmington, **Tyrel G. Moore**, UNC at Charlotte, and **Stephen Walsh**, UNC at Chapel Hill. Also: **Derek H. Alderman**, East Carolina Univ.

OFFICERS, ASSN. OF AMER. GEOGRAPHERS

President:	Richard A. Marston , Kansas State Univ.
Vice President:	Kavita K. Pandit , University of Georgia
Secretary:	Jon T. Kilpinen , Valparaiso University
Treasurer:	Samuel Aryeetey-Attoh , Univ. of Toledo
Past President:	Victoria Lawson , Univ. of Washington
Executive Director:	Douglas Richardson , AAG Headquarters, Washington, D.C.

SEDAAG HONORS COMMITTEE

Timothy Warner, Chair, West Virginia University
Katie Algeo (chair elect), Western Kentucky Univ.
Dan Royall, UNC at Greensboro
Jim Young, Appalachian State University
Hilda Kurtz, University of Georgia, Athens

WORLD GEOGRAPHY BOWL COMMITTEE

Laurence W. Carstensen, Chair, Virginia Tech
Thomas Bell, University of Tennessee
Jennifer Collins, University of South Florida
Thomas Deaton, Dalton State College
Dennis Edgell, UNC at Pembroke
Kelly Gregg, Jacksonville State University
Margaret Gripshover, University of Tennessee
Joe Guttman, University of Tennessee
Elizabeth Leppman, Writer, Map and Book Editor
Neal Lineback, Appalachian State University
Dorothy Mason, Independent Scholar
Jeffrey Neff, Western Carolina University
Dennis Spetz, Emeritus, University of Louisville
Harry Trendell, Kennesaw State University

PROGRAM AT A GLANCE

PREMEETING - SATURDAY, NOV. 19, 2005

<u>Time</u>	<u>Description</u>	<u>Location</u>
8:00 - 6:00 pm	National Council Bus. Mtg.	Gallery A & B
12:00 - 6:00 pm	Early Registration	Lobby Foyer
1:30 - 5:00 pm	World Geography Bowl Committee Meeting (WGB Committee Members Only)	Sanibel 1&2

Field Trip #1 - Loxahatchie National Wildlife Refuge

Departs at 1pm from main lobby entrance and returns by 6pm.

Led by **Dr. Jacqueline Gallagher**, Florida Atlantic Univ.

DAY 1, SUNDAY, NOVEMBER 20, 2005

8:00am-6:00pm	SEDAAG Registration	Lobby Foyer
12:00 - 5 pm	Vendor & Dept. Displays	Regency A
8:00 - noon	AAG National Council Mtg.	Polo E & F
Noon - 3:00pm	Exec. & Steering Comm. Mtg.	Regency E

Field Trip #2 - W. Palm Beach, Palm Beach & Lake Worth

Lagoon. Departs at 1pm from main lobby entrance and returns by 6pm. Led by **Dr. Charles Roberts**, Florida Atlantic Univ.

2:30 - 5:00 pm **Workshop: Effective Teaching for Early Career Faculty and Graduate Students.** Organized by the Geography Education Committee: **Eric Fournier**, Samford Univ., **Heather Smith**, UNC at Charlotte, and **Doug Oetter**, Georgia College & State Univ. Pre-register: ejfourni@samford.edu Polo E & F

World Geography Bowl (WGB) Round Robin Competitions

12:00 - 1:30 pm	Team Registration & Orientation	Salon D
1:30 - 5:30 pm	Round Robins	Salon D, Gallery A, B, C, Sanibel 1
5:30 - 6:00 pm	Winning teams & All-stars announced	Salon D

Opening Session

8:00 - 9:15 pm	Salon D
----------------	---------

Call to Order: Welcome to the 60th Annual Meeting of SEDAAG.

Stephen J. Walsh, University North Carolina at Chapel Hill, President, SEDAAG.

Introduction: **Russ Ivy**, Chair, Local Arrangements Committee, Florida Atlantic University. Welcome to West Palm Beach and Southern Florida.

Keynote presentation: **Dr. Stephen Leatherman**, Director, International Hurricane Research Center, Florida International University. Title: "*Hurricanes that Changed Public Policy.*"

9:15-11:00 pm **Opening social** with Mighty Monarchs Calypso band and cash bar. Outdoor Pavillion

Session 27 - Political Geography

Tuesday 8:00 am - 10:00 am - Gallery C

Organizer and Chair: **Gerald Webster**, University of Alabama

Discussant: **Jason Dittmer**, Georgia Southern University

Thomas Chapman and Jonathan Leib. Florida State Univ. -

Political Geographies of Same-Sex Marriage in Georgia.

Micheala Denny. Florida State Univ. - *The Politics of Space at the Florida State University.*

Olga Smirnova and Jerry Ingalls. UNC at Charlotte - Influence of State Annexation Laws on Growth of Selected Southern Cities.

Luis Sánchez. Florida State Univ. - *The Political Status, a question of identity?: The Case of Cuban and Dominicans in Puerto Rico.*

Gerald R. Webster, Jerrod Bowman, Daniel McGowin, and Heath Robinson. Univ. Alabama - *Research on the Political Geography of the South, 1980-2005.*

Session 28 - Ethnic Labor, Migration, and Tourism

Tuesday 8:00 am - 10:00 am - Polo D

Chair: **Altha Cravey**, UNC at Chapel Hill.

Qingfang Wang. UNC, Charlotte - *Earnings Effect of Ethnic Labor Market Segmentation in Multi-Racial Metropolitan Contexts.*

Discussant: **Altha Cravey**, UNC at Chapel Hill.

Paul N. McDaniel. Univ. Tennessee - "¿Cuál es su trabajo?": Labor Characteristics of the Hispanic Community in Birmingham, Alabama.

Discussant: **Altha Cravey**

Abigail Foulds. Univ. Kentucky - *I Want to Live in the Sun!*

Expatriates in the Contemporary Global Community. Discussant:

Ronald Schultz, Florida Atlantic Univ.

Amanda Rees. Constructing the American West: Dude Ranching, Class, and Popular Culture 1920-1945. Discussant: **Bill O'Brien**, Florida Atlantic Univ.

Session 29 - Food and Health

Tuesday 8:00 am - 10:00 am - Polo E

Chair: **Rebecca Torres**, East Carolina Univ.

Ben Deck. East Carolina Univ. - *Alternative agriculture: A case study in northeast North Carolina.* Discussant: **Mitch Chapura**, Univ. Georgia.

Holly Worthen. UNC-Chapel Hill - *Finding a Way: Women, Corn, and Migration in Veracruz, Mexico.* Discussant: **Rebecca Torres**, East Carolina Univ.

Mitch Chapura. Univ. Georgia - *Hunger, Hope and Hubris: The Green Revolution and Current Debates on Agricultural Biotechnology.* Discussant: **Vicky Berry**, Winston-Salem St.

Korine N. Kolivras. Virginia Tech. *Stigma and mosquito-borne disease: A case study of the 2001-2002 Hawaiian dengue outbreak.*
Discussant: **Ben Deck**, East Carolina Univ.

Tuesday Period 5 - 8:00 am - 10:00 am

Session 25 - Environmental Applications of GIScience

Tuesday 8:00 am - 10:00 am - Gallery A

Chair: **Ross Meentemeyer**, UNC at Charlotte.

Ross K. Meentemeyer, David M. Rizzo, Walter Mark, and Brian L. Anacker. UNC at Charlotte, Univ. Calif. Davis, Cal. Polytechnic State Univ., and Sonoma State Univ. - *Early detection and estimation of the distribution of the invasive pathogen causing Sudden Oak Death in California.* Discussant: **Stephen Walsh**, UNC at Chapel Hill.

Carlos F. Mena. UNC at Chapel Hill - *Demographic, Socioeconomic, and Biophysical Factors Affecting Land Use and Land Cover Change in the Northern Equadorian Amazon...* Discussant: **Ross Meentemeyer**, UNC at Charlotte.

Erlien, C.M., C.F. Mena, and S.J. Walsh. UNC at Chapel Hill - *Land Use and Land Cover Change in and Around Protected Areas: The Case of the Cuyabeno Wildlife Production Reserve, Ecuador.* Discussant: **Ross Meentemeyer**, UNC at Charlotte.

Russel Taylor and Gang Wang. Univ. Alabama - *Modeling Nutrient Dynamics for the Tallapoosa River Watershed Using a GIS Based Hydrological Model.* Discussant: **Stephen Walsh**, UNC at Chapel Hill.

Session 26 - Climate II

Tuesday 8:00 am - 10:00 am - Gallery B

Chair: **Charles E. Konrad, II**, UNC at Chapel Hill.

J. Anthony Stallins. Florida State Univ. - *Suburban hotspots: patterns of lightning flash production in Atlanta, Georgia.* Discussant: **Corene Matyas**, Univ. Florida.

Baker Perry and Charles E. Konrad, II. Appalachian State Univ. and UNC at Chapel Hill - *Synoptic Climatology of Northwest Flow Snowfall in the Southern Appalachians.* Discussant: **J. Anthony Stallins**, Florida State Univ.

Jeremy E. Diem. Georgia State Univ. - *Northward Extension of Intense Monsoonal Activity into the Southwestern United States.* Discussant: **Scott Curtis**, East Carolina Univ.

Jonathan Herbert. Jacksonville State Univ. - *The Climate of Big Bend National Park, Texas.* Discussant: **Jeremy E. Diem**, Georgia State Univ.

DAY 2

Time

MONDAY NOVEMBER 21, 2005

Description

Location*

SEDAAG Registration and Information

8:00 a.m. - 5:00 pm Registration

Lobby Foyer

8:00 a.m. - 5:00 pm Vendors & Departments

Regency A

Paper, Panel, and Poster Sessions

8:00 - 10:00 am Session 1: Student Honors Competition I RmA

8:00 - 10:00 am Session 2: Urban applications of GIScience RmB

8:00 - 10:00 am Session 3: Storms in the South RmC

8:00 - 10:00 am Session 4: Southern Settlement Patterns RmD

8:00 - 10:00 am Session 5: Economic Geography RmE

9:00 - 11:30 am Session 6: Posters I: Environmental Topics

Presenters will be by their posters from 10-11:00 am

Regency A

10:15 - 12:15 pm Session 7: Student Honors Competition II RmA

10:15 - 12:15 pm Session 8: Jamaica: Tourism & Env. RmB

10:15 - 12:15 pm Session 9: Climate I RmC

10:15 - 12:15 pm Session 10: Southern Culture RmD

10:15 - 12:15 pm Session 11: Education & Info Tech RmE

10:15 - 12:15 pm Session 12: Stand-alone Geographers Panel RmF

1:15 - 3:15 pm Session 13: Suburban & ExUrban Changes RmA

1:15 - 3:15 pm Session 14: Caribbean I RmB

1:15 - 3:15 pm Session 15: Southern Studies RmC

1:15 - 3:15 pm Session 16: Politics of Community RmD

1:15 - 3:15 pm Session 17: Geomorph & Hydrology RmE

1:15 - 3:15 pm Session 18: Geographic Issues in Africa RmF

3:30 - 5:30 pm Session 19: GTU Undergraduate papers RmA

3:30 - 5:30 pm Session 20: Caribbean II RmB

3:30 - 5:30 pm Session 21: Global & European Viewpts RmC

3:30 - 5:30 pm Session 22: Southern Justice Panel RmD

3:30 - 5:30 pm Session 23: Professional Dev. Panel RmF

3:30 - 5:30 pm Session 24: Posters II: Human Topics

Presenters will be by their posters from 4:30-5:30 pm

Regency A

5:45-7:15 pm

WGB Championship Event

Salon D

* RmA, RmB & RmC are Gallery rooms; RmD, RmE & RmF are Polo rooms (see map on back cover).

DAY 2 MONDAY, NOVEMBER 21, 2005 (continued)

PROGRAM AT A GLANCE (continued)

<u>Time</u>	<u>Description</u>	<u>Location</u>
7:30 - 10:00 pm	Honors Banquet and Address	Regency A
	Tim Warner Presiding, Chair, Honors Comm., West Virginia Univ.	
	Honors Address: Richard A. Marston , President, AAG, Kansas State University. Title: Geographers Collaborating to Solve Complex Environmental Problems”	

DAY 3: TUESDAY, NOVEMBER 22, 2005

8:00 - 10:00 am	Session 25: Env. Applications of GISci	RmA
8:00 - 10:00 am	Session 26: Climate II	RmB
8:00 - 10:00 am	Session 27: Political Geography	RmC
8:00 - 10:00 am	Session 28: Labor, Migration & Tourism	RmD
8:00 - 10:00 am	Session 29: Food & Health	RmE
8:00 - 10:00 am	Session 30: Culture and Landscapes	RmF

Business Meeting

10:15 am - 12:15 pm	Sanibel 1&2
	Stephen J. Walsh , Presiding, President, SEDAAG, UNC at Chapel Hill Address by Doug Richardson , Executive Director of AAG

2005 SEDAAG WORLD GEOGRAPHY BOWL SUNDAY, NOVEMBER 20, 2005

Round Robin Competitions

12:00 - 1:30 pm	Team Registration	Salon D
1:30 - 5:30 pm	Round Robins	Salon D, Gallery A, B, C, Sanibel 1
5:30 - 6:00 pm	Announce winning teams and All-stars	Salon D

Event Organizers: World Bowl Committee, chaired by **Laurence W. Carstensen**, Virginia Tech.

Moderators:

Sara Beth Keough, University of Tennessee
Harry Trendell, Kennesaw State
Korine Kolivras, Virginia Tech
Joe Guttman, University of Tennessee

Judges:

Tom Bell - University of Tennessee
Peggy Gripshover - University of Tennessee
Jennifer Collins - University of South Florida
Thomas Ross - UNC at Pembroke

Official Scorekeeper:

James E. Young, Appalachian State Univ.

Session 24 - Posters II: Cultural and Urban Topics

Monday 3:30 pm - 5:30 pm - Regency A

Presenters will be by their posters from 9:00 to 10:00 am

1. **Justin Gross**. East Carolina Univ. - *Town-Gown Relations and Explorations of a Transient University Neighborhood*.
2. **Joseph Guttman**. Univ. Tennessee - *Mapping Religious Trends in East Tennessee, 1990-2000*.
3. **Laura Heavner**. East Carolina Univ. - *The Power of Photography: Measuring Levels of Gender and Racial/Ethnic Representation*.
4. **Amy Nicholson**. East Carolina Univ. - *Housing on the Run: A History of the American Nomad*.
5. **Patrick Smith**. Univ. Southern Mississippi - *Hot Water: The Distribution of Public Swimming Pools in Mississippi 1967-1971*.
6. **Timothy Tresohlavsky, Joseph Luchette, Paul Black, and Chris Lukasina**. East Carolina Univ and Upper Coastal Plain Council of Govts. (Black and Lukasina) - *Long-range Transportation Planning Utilizing Local Land-use Data in Rural North Carolina*.
7. **Sallie Vaughn**. East Carolina Univ. - *The Importance of Trading Paths to Late Classic Maya Settlement Locations: Northwestern Belize*.
8. **Timothy Warner, Rick Landenberger, and M. Duane Nellis**. Univ. West Virginia and (Nellis) Kansas State Univ. *West Virginia View: An AmericaView state remote sensing consortium*.
9. **Angela Worley and Johan Liebens**. Univ. West Florida - *Relationships between health outcomes and air pollution in Northwest Florida*.
10. **Shouhong Xie and Lisa Drummond**. York Univ., Canada - *The Development of Big Cities and the Formation of Metropolitan Areas in Contemporary China*.

MONDAY EVENING HONORS BANQUET AND ADDRESS

7:30-10:00 pm	Honors Banquet	Regency A, B, C
---------------	----------------	--------------------

Tim Warner, Presiding
Chair, Honors Committee, West Virginia University

Honors Address: Richard A. Marston, President, Assn. of American Geographers, Kansas State University:
“Geographers Collaborating to Solve Complex Environmental Problems”

Session 21 - Global and European Viewpoints

Monday 3:30 pm - 5:30 pm - Gallery C

Chair: **Ann Oberhauser**, West Virginia Univ.

Edward R. Carr, University of South Carolina. *Losing the Local in Postdevelopment*. Discussant: **Jonathan D. Lepofsky**, UNC at Chapel Hill.

Daniel B. Reader, Western Kentucky Univ. - *The Ethics of Sustainability and Globalization*. Discussant: **Kirstin Dow**, Univ. South Carolina.

Chris Blackden, Univ. Kentucky - *The WTO as a Quasi-State*. Discussant: **Daniel B. Reader**, Western Kentucky Univ.

Harlow Z. Head, Barton College - *Paris Red Belt—the Landscape of the Communist Suburbs*. Discussant: **Georgeta Stoian Connor**, Univ. Georgia.

Georgeta Stoian Connor, Univ. Georgia - *A New Context for Theorizing European Integration: Bulgaria's and Romania's Integration Into The European Union*. Discussant: **Harlow Z. Head**, Barton College.

Session 22 - Southern Justice Panel:

Toward a Critical Understanding of

Social Justice and Geography in the American South

Monday 3:30 pm - 5:30 pm - Polo D

Organizers: **Derek H. Alderman** and **Joshua Inwood**, East Carolina Univ. and Univ. Georgia.

Moderator: **Derek H. Alderman**, East Carolina Univ.

Panelists: **Josh Inwood**, Univ. Georgia, **Hilda Kurtz**, Univ. Georgia, **Heather Smith**, UNC-Charlotte, **Barney Warf**, Florida State Univ., **Gerald Webster**, Univ. Alabama, **Bobby Wilson**, Univ. Alabama, **Tony Plakas**, Exec. Dir., Compass GLCC, **Jamie Foreman**, Pres. Palm Beach County Human Rights Council.

Session 23 - Professional Development Panel

Negotiating Tenure and the Probationary Years

Monday 3:30 pm - 5:30 pm - Polo F

Organizers: Committee on the Status of Women in Geography; **Holly Hapke**, East Carolina Univ.

Moderator: **Helen Ruth Aspaas**, Virginia Commonwealth Univ.

Panelists:

Kavita Pandit, University of Georgia

Ron Mitchelson, East Carolina University

Amanda Rees, Columbus State University

Jennifer Mandel, University of Miami

WORLD GEOGRAPHY BOWL (continued)

MONDAY, NOVEMBER 21, 2005

Participating Teams and State WGB Coordinators:

Alabama: **Lisa Boulton**, Univ. Alabama

Florida: **Tony Stallins & Sharon Cobb**, Florida State Univ.

Georgia: **Vernon Meentemeyer**, Univ. Georgia

Kentucky: **Elizabeth Leppman**, Writer, Map and Book Editor

Mississippi:

North Carolina: **Jay Lennartson**, UNC at Greensboro

South Carolina: **Jerry Mitchell**, Univ. So. Carolina

Tennessee:

Virginia: **Joe Nicholas & Dawn Bowen**, Univ. Mary Washington

West Virginia: **Jan Westerik**, Concord College

5:45 - 7:15 pm Dream Team v. All-Stars Warm-up & Finals

Moderator: **Laurence W. Carstensen**, Virginia Tech

Judges: **Thomas Deaton**, Chief Judge, Dalton State College

Neal Lineback, Appalachian State University

Kelly Gregg, Jacksonville State University

Thomas Bell, University of Tennessee

Warm-up Round: Dream Team v. Student All-Stars Salon D

Student All-Stars: Drawn from the six Sunday preliminary rounds.

Dream Team:

Richard A. Marston, President Association American Geographers (AAG), Kansas State Univ.

Douglas Richardson, Executive Director, AAG, Mercator Place

Stephen J. Walsh, SEDAAG President, UNC at Chapel Hill.

Tyrel Moore, Regional Councillor to AAG, UNC at Charlotte.

Scott Lecce, Co-Editor *Southeastern Geographer*, East Carolina Univ.

Douglas Gamble, SEDAAG Secretary, UNC at Wilmington.

Southeast Regional Championship Round: The top two state teams from the Southeast Division compete in a single Championship Round, winner takes all. Trophies to the winning team and to the Most Valuable Player.

PAPER & POSTER SESSIONS

MONDAY, NOVEMBER 21, 2005

Monday Period 1

Session 1 - SEDAAG Honors Competition I

Monday 8:00 am - 10:00 am - Gallery A

Organizer and chair: **Timothy Warner**, West Virginia University.

Matthew S. Cox, Univ. West Florida - *Ecotourism in Walton County, Florida*.

Sarah Schwartz, Univ. South Carolina - *Discourse as a Means of Understanding Ecotourism: An Example from Wechiau, Ghana*.

Stephanie Simon, Univ. Kentucky - *Is Public Space the Place? Interrogating the Crowd as a Political Actor*.

Robert A. Yarbrough, Univ. Georgia - *Becoming Hispanic: The Negotiation of Racialized Identities Among Central American Immigrants in Atlanta, GA, USA*.

Marcia England, Univ. Kentucky - *When Good Neighbors go Bad: The Effect of Good Neighbor Agreements on Neighborhoods*.

Session 2 - Urban Applications of GIScience

Monday 8:00 am - 10:00 am - Gallery B

Chair: **Lawrence W. Carstensen**, Virginia Tech.

Michael Bacon and James Fraser, UNC at Chapel Hill. *Examining Neighborhood Revitalization and Crime: Using Cluster Detection Techniques to Analyze Shifts in Crime Patterns*. Discussant: **Paul Zandbergen**, Univ. South Florida.

Hu, Zhiyong, Univ. West Florida. *Stochastic Modeling of Land Use Dynamics in Atlanta, Georgia*. Discussant: **Paul Zandbergen**, Univ. South Florida.

Bandana Kar, Univ. South Carolina. *A GIS-Based Suitability Model to Determine Emergency Evacuation Shelters*. Discussant: **Lawrence W. Carstensen**, Virginia Tech.

Matthew A. Zook and Mark Graham, Univ. Kentucky. *GoogleSpace and the Variable Geometries of DigiPlace*. Discussant: **Lawrence W. Carstensen**, Virginia Tech.

Xiaobai Yao, Univ. Georgia, Athens. *Computation of Conditioned Network Distance*. Discussant: **Bandana Kar**, Univ. South Carolina.

Monday Period 4 - 3:30 pm - 5:30 pm

Session 19 - GTU Undergraduate Papers

Monday 3:30 pm - 5:30 pm - Gallery A

Chair: **Howard Johnson**, Jacksonville State Univ.

Rebecca Troyer - Jacksonville State Univ. - *Mapping Woodland Archaeological Sites in Alabama to Determine Water Resource Preferences*.

Kathleen Strempel - Jacksonville State Univ. - *Changing Precipitation in Alabama Between 1950 and 2004*.

Michael Levensgood and Emily Powers, Univ. Georgia - *New Urbanism: Atlantic Station* (video presentation).

Session 20 - Caribbean II: Transnational Geographies

Monday 3:30 pm - 5:30 pm - Gallery B

Organizers: **Rebecca Torres & M. Victoria Berry**, East Carolina Univ. & Winston-Salem State

Chairs: **M. Victoria Berry & Rebecca Torres**, Winston-Salem State & East Carolina Univ.

Sponsor: *Southeastern Geographer* (Alderman & Lecce, Eds.)

Discussant: **Thomas Boswell**, University of Miami.

Tamara Johnson and Linda Quiquix, UNC at Chapel Hill - *Spatial Challenges to Immigrant Assimilation and Trans-nationalism Research: A case study of Dominican immigrants in urban New York City and suburban North Carolina*.

Beth Mills, Santa Fe County - *The Transnational Community as an Agent for Caribbean Development: Aid from New York City and Toronto to Carriacou, Grenada*.

Kevon Rhiney, Univ. West Indies - *An Investigation into the Nature of Linkages Existing Between the Local Food-Supply Network and the Tourism Industry in Jamaica: A Case Study of Negril*.

David Cochran, Univ. Southern Mississippi - *Who will Work the Land? Emergent Market Economies and the Future of Shifting Cultivation in the Mosquitia Region of Eastern Honduras*.

Vanessa Slinger-Friedman, Kennesaw State Univ. - *Ecotourism in Dominica: Studying the Potential for Economic Development and Nature Preservation*.

Session 17 – Geomorphology and Hydrology

Monday 1:15 pm - 3:15 pm - Polo E

Chair: **Carol Harden** and **Daniel Royall**, UNC at Greensboro and Univ. Tennessee.

Alice Turkington, Univ. Kentucky - *Microtopography of limestone in a semi-arid area*. Discussant: **Carol Harden**, Univ. Tennessee.

Heidi Lannon, Gainesville Regional Utilities - *Geomorphic variability and the suitability of coastal land use, Northeast Florida*. Discussant: **Graham Tobin**, Univ. South Florida.

Chris Houser, Ian Walker, and Dilumie Abeyesirigunawardena, Univ. West Florida (Houser) and Univ. Victoria, B.C. - *Morphodynamics of a Low-Amplitude Ridge of a Macrotidal Beach*. Discussant: **Johan Liebens**, Univ. West Florida.

David Shankman, Barry D. Keim, and Jie Song, Univ. Alabama, LSU, and Northern Illinois Univ. - *Flood Prediction in China's Poyang Lake Region*. Discussant: **Michael Mayfield**, Appalachian State Univ.

William C. Aycock and Yong Wang, City of Wilson, NC and East Carolina Univ. - *Study of citizen drainage complaints using the 100-year flood zones of the flood maps and stream buffers outside the flood zones*. Discussant: **Daniel Royall**, UNC at Greensboro.

Session 18 – Geographic Issues in Africa

Monday 1:15 pm - 3:15 pm - Polo F

Chair: **Edward Carr**, Univ. South Carolina

Ann M. Oberhauser and Kobena Hanson, West Virginia Univ. - *Re-Scaling Household Strategies: Livelihood Diversification in Accra, Ghana*. Discussant: **Edward Carr**, Univ. South Carolina.

J. Kopf, Georgia Southern Univ. - *Hybridity in colonial East Africa*. Discussant: **Seth Appiah-Opoku**, Univ. Alabama.

Linda Wang, Univ. South Carolina, Aiken - *The Power of Interracial Communication: the Truth and Reconciliation Commission in South Africa*. Discussant: **Ann M. Oberhauser**, West Virginia Univ.

Charles Alan Gray, II and Seth Appiah-Opoku, Univ. Alabama - *Culture and Natural Resource Exploitation in Ghana: Observations from Alabama in Ghana Summer Abroad Trip*. Discussant: **Edward Carr**, Univ. South Carolina.

Session 3 - Storms in the South: Human & Physical Aspects

Monday 8:00 am - 10:00 am - Gallery C

Organizer and Chair: **Scott Curtis**, East Carolina Univ.

Discussant: **Doug Gamble**, UNC-Wilmington.

Scott Curtis, East Carolina Univ. - *ENSO Impacts on Climatology of Winter Extratropical Cyclones in the Southeast U.S.*

Corene Matyas, Univ. Florida - *Relating Tropical Cyclone Rainfall Patterns To Storm Size*.

Graham A. Tobin and Heather M. Bell, Univ. South Florida - *Social Vulnerability of Relocation Park Residents in the Wake of Hurricane Charley*.

Elizabeth J. Leppman, Eastern Kentucky Univ. - *Hurricane Katrina in Political Cartoons*.

Derek H. Alderman and Amy L. Nicholson, East Carolina Univ. - *The Writing on the Plywood: An Analysis of Hurricane Graffiti in the Southeastern U.S.*

Session 4 - Southern Settlement Patterns

Monday 8:00 am - 10:00 am - Polo D

Chair: **Selima Sultana**, UNC at Greensboro

Selima Sultana and Joe Weber, UNC at Greensboro & Univ. of Alabama - *Employment Sprawl and the Journey to Work: Linking the Home and Workplace*. Discussant: **George Towers**, Concord Univ.

Joe Weber and Selima Sultana, Univ. Alabama & UNC at Greensboro - *A Fine Scale Analysis of Urban Sprawl and Commuting in Alabama*. Discussant: **Truman Hartshorn**, Georgia State Univ.

George Towers, Joseph Manzo, Todd Sink, and Eric Combs, Concord Univ. & Indiana State Univ. (Sink) - *Rural Sprawl without Population Growth? Measuring Sprawl's Impact in Southern West Virginia*. Discussant: **Joe Weber**, Univ. Alabama.

Claire Jamieson, Univ. Tennessee - *Transformations of the Southern Mill Village Landscape: Newry, South Carolina*. Discussant: **Selima Sultana**, UNC at Greensboro.

Deborah Thompson, Univ. Kentucky - *Spaces of Hope: Intentional Communities in Appalachia*. Discussant: **Thomas Chapman**, Florida State Univ.

Session 5 - Economic Geography
Monday 8:00 am - 10:00 am - Polo E

Chair: **Sharon C. Cobb**, Univ. North Florida
Ronald V. Kalafsky, UNC at Charlotte - *Transitions in new industrial environments: the case of Charlotte manufacturers*. Discussant: **Kelly D. Gregg**, Jacksonville State Univ.
Sharon C. Cobb, Univ. North Florida - *Credit Union marketing strategies and their spatial implications in Florida*. Discussant: **Ronald V. Kalafsky**, UNC at Charlotte.
William Graves and Stuart Hair, UNC at Charlotte - *Money, Regulation and Information: Identifying the New Geography of Modern Banks*. Discussant: **Sharon C. Cobb**, Univ. North Florida.
David J. Doran, Jr., Georgia State Univ. - *Wharves to Waterfalls: The Geo-politics of the Massachusetts Economy. A Geographical Analysis: 1804 – 1837*. Discussant: **Thomas W. Crawford**, East Carolina Univ.
Kelly D. Gregg and Jami Hill, Jacksonville State Univ., Alabama - *The Jacobs Brothers - Jewish Merchants on the Arizona frontier: A study in the geography of transportation*. Discussant: **David Prosper**, Florida Atlantic Univ.

Session 6 - Posters I: Environmental Topics
Monday 9:00 am - 12:00 pm- Regency A

Presenters will be by their posters from 10:00-11:00 am
1. **Arvind Bhuta, Lisa Kennedy, Carolyn Copenheaver, and Philip Sheridan**, Virginia Tech. *The Population Dynamics of Longleaf Pine at its Northernmost Range*.
2. **Lisa Boulton**, Univ. Alabama. *Reach Scale Sediment Processes in a Channelized Tributary*.
3. **Rebecca A. Click and Korine N. Kolivras**, Virginia Tech. *Climate Variability and the Potential Spread of Chagas Disease in North America*.
3. **Christopher M. Fuhrmann and Charles E. Konrad, II**, Univ. Georgia and UNC at Chapel Hill. *Does Charlotte, NC Create It's Own Weather? An Examination of Possible Urban Enhancement*.
4. **Jerry Griffith, D. Caviness, and G. Hennington**, Univ. So. Miss. *Creation of a GIS Database for Mississippi's Wetland Permits*.
5. **Carol Harden**, Univ. Tenn. *Soils and the Glacial History of Cajas National Park*.

Session 15 - Southern Studies
Monday 1:15 pm - 3:15 pm - Gallery C

Chair: **Tyrel G. Moore**, UNC at Charlotte
Organizers: **Tyrel G. Moore** and **Dawn S. Bowen**, UNC at Charlotte and Univ. Mary Washington.
Dawn S. Bowen, Univ. Mary Washington - *Race, Residence and Mobility in Richmond, Virginia: 1900 – 1930*. Discussant: **Tyrel Moore**, UNC at Charlotte.
John B. Strait and Cherisha N. Williams, Louisiana Tech Univ. - *Rubbing Elbows in the Big Easy: The Impacts of Compositional and Redistributive Forces on Residential Segregation Among Racial and Ethnic Groups in New Orleans, Louisiana; 1990-2000*. Discussant: **Jerry Ingalls**, UNC at Charlotte.
Harold R. Trendell and Agatino La Rosa, Kennesaw State Univ. - *Growth Patterns of Latino Businesses in Cobb County, Georgia*. Discussant: **Dawn Bowen**, Univ. Mary Washington.
Katie Algeo, Western Kentucky Univ. - *Cultivating the Grape in a Dry Climate*. Discussant: **Michael Crutcher**, Univ. Kentucky.
Tyrel G. Moore and Gerald L. Ingalls, UNC at Charlotte - *Old But Newsworthy: Textile Mill Reuse in the Charlotte Urban Region, 2001-2005*. Discussant: **Harold Trendell**, Kennesaw State.

Session 16 - The Politics of Community
Monday 1:15 pm - 3:15 pm - Polo D

Chair: **Katherine B. Hankins**, Univ. Georgia
Organizers: **Katherine B. Hankins** and **Jennifer Speights-Binet**, Univ. Georgia and Univ. Houston, Clear Lake.
Discussant: **Derek H. Alderman**, East Carolina Univ.
Katherine B. Hankins, Univ. Georgia. *Producing, Consuming, and Rescaling Community through the Creation of a Charter School*.
Jennifer Speights-Binet, Univ. Houston, Clear Lake - *Framing Community: A New Urban Case Study*.
Jonathan D. Lepofsky, UNC at Chapel Hill. *Territorializing the Local: The Spatial Politics of Ethics and Community in a Complementary Currency*.
Heather A. Smith and Owen J. Furuseth, UNC at Charlotte - *Making Real the Mythical Latino Community in a New South City*.

Monday Period 3 - 1:15 pm - 3:15 pm

Session 13 - Recent Changes in U.S. Suburban & Ex-Urban Areas Monday 1:15 pm - 3:15 pm - Gallery A

Chair and Organizer: **James O. Wheeler**, Univ. Georgia.

Truman Hartshorn, Georgia State Univ. - *Recent Changes in Suburban Downtowns in Atlanta*. Discussant: **William Graves**, UNC at Charlotte.

Susan M. Walcott, Georgia State Univ. - *Metropolitan Atlanta's New Borders: Pushing the Limit?* Discussant: **William Graves**, UNC at Charlotte.

Richard Greene, Northern Illinois Univ. - *Job Growth Trends in the Employment Centers of Los Angeles: 1990-2000*. Discussant: **James Leonard**, Marshall Univ.

Thomas W. Crawford, East Carolina Univ. - *Time-space characterization of residential sprawl in a coastal setting*. Discussant: **Susan M. Walcott**, Georgia State Univ.

James Leonard and **Sarah Brinegar**, Marshall Univ. - *Economic Segregation and Urban Expansion 1970-2000: A Comparative Analysis of the Metropolitan Regions of Cincinnati, Cleveland, and Columbus, Ohio*. Discussant: **Richard Greene**, No. Illinois Univ.

Session 14 - Caribbean I: Human & Env. Relations Monday 1:15 pm - 3:15 pm - Gallery B

Sponsor: Southeastern Geographer (Alderman & Lecce, Eds.)

Organizers: **Rebecca Torres** & **M. Victoria Berry**, East Carolina Univ. & Winston-Salem State.

Chairs: **M. Victoria Berry** & **Rebecca Torres**

Discussant: **Gail Hollander**, Florida International Univ.

David Barker and **Clinton Beckford**, Univ. West Indies and Univ. Windsor, Canada - *Yam Farming and the Yam Stick Problem in Jamaica: the Role of Farmer's Indigenous Knowledge in the Search for Sustainable Solutions*.

M. Victoria Berry, Winston-Salem State - *Potential Contributions of Amerindians to Caribbean Folk Medicine*.

Doug Gamble, UNC at Wilmington - *Spatial Analysis of the Caribbean Mid-summer Drought*.

Erin P. Hughey, Univ. South Florida - *Island Nations and All-Hazard Planning: The Commonwealth of the Bahamas*.

Billy Terry, Univ. South Carolina - *Taking a Critical Cruise*.

Posters I: Environmental Topics (continued)

6. **Dasen Kendrick** and **Rezaul Mahmood**, Western Kentucky Univ. - *Relationship Between Mesometeorological Patterns and Ground Ozone Concentration Variability*.

8. **Laura L. Knight**, Univ. Georgia. - *Remote Sensing Applications in Underwater Archeological Mapping*.

9. **Scott A. Lecce**, East Carolina Univ. - *A Depth-Proportional Sampling Device for Automatic Samplers*.

10. **Michael W. Mayfield** and **Christian Degrassi**, Appalachian State Univ. and Cypress College. - *Snow and Ice Changes in the Cordillera Real, Bolivia, 1987-2001*.

11. **Mary Snow** and **Richard Snow**, Embry-Riddle Aeronautical Univ. - *GIS Analysis of Sea Turtle Nesting Sites in Volusia County, Florida*.

12. **Peter Soulé**, Appalachian State Univ. - *Are Growth Rates of Ponderosa Pine in the Pacific NW Related to Atmospheric Carbon Dioxide?*

13. **Gang Wang** and **Russel Taylor**, Univ. Alabama. - *Uncertainty Analysis of a GIS Based Hydrological Model: the Middle Tallapoosa River Watershed*.

14. **Sol Wuensch**, **Jennifer Ast**, and **Scott Curtis**, East Carolina Univ. - *North Carolina 2004 Hurricane Season: Death, Destruction, and Chaos*.

Monday Period 2 - 10:15 am - 12:15 pm

Session 7 - SEDAAG Honors Competition II Monday 10:15 am - 12:15 pm - Gallery A

Organizer: **Timothy Warner**, West Virginia University

Chair: **Katie Algeo**, Western Kentucky University

Joshua D. Durkee, University of Georgia - *The Spatial and Temporal Variability in Mesoscale Convective Complex Precipitation Efficiency*.

George Roedl, West Virginia University - *An Exploratory Comparison in LULC and LULC Changes Between Six Counties in South Mississippi: 1985-1999*.

Matt Schmittlein, University of South Carolina - *A SOM-based Sensitivity Analysis of the Social Vulnerability Index*.

E. Spencer Fleury, University of South Florida - *A Geographic Approach to School Choice and Economic Stratification: Results From Hillsborough County and Pinellas County, Florida*

Haifeng Zhang, University of South Carolina - *The Geographic Analysis of Public-Private School Choice in South Carolina*.

Session 8 - Jamaica: Tourism and Environment

Monday 10:15 am - 12:15 pm - Gallery B

Organizer and Chair: **Jason Dittmer**, Georgia Southern Univ.

Discussant: **Andy Walter**, Univ. West Georgia.

Jason Dittmer, Georgia Southern Univ. - *Ian Fleming's Jamaica: Spaces of Legitimation and the Bond-age of Popular Culture.*

David Dodman, Univ. West Indies, Mona, Kingston - *Mixing Methods In Montego Bay: Contrasting Findings From Constrasting Techniques.*

Soren Larsen, Univ. Missouri - *Negril in the News: Content Analysis of a Contested Paradise.*

Susan P. Mains, Univ. West Indies-Mona - *Island Village, Tourist World: Understanding Design, Development, and Destination in Ocho Rios, Jamaica.*

Jeff Ueland, Ohio Univ. - *An examination of recent historical trends in sea surface temperature in the Caribbean Basin and Jamaica.*

Session 9 - Climate I

Monday 10:15 am - 12:15 pm - Gallery C

Chair: **J. Anthony Stallins**, Florida State Univ.

Paul Zandbergen, Univ. South Florida - *Which US County has been hit the most by Atlantic tropical storms and hurricanes?*

Discussant: **Darren Parnell**, Kutztown Univ. of Pennsylvania.

Jeff Martin, Jacksonville Univ. - *Tropical Storm Induced Tree Damage in an Urban Landscape.* Discussant: **J. Anthony Stallins**, Florida State Univ.

Charles E. Konrad, II, Baker Perry, and Adam Smith, II, UNC at Chapel Hill, Appalachian State Univ., and National Climate Data Center - *Regional Variations in the Synoptic Patterns associated with Warm Season Heavy Rainfall across the Eastern U.S.* Discussant: **Jeremy E. Diem**, Georgia State Univ.

Darren B. Parnell, Kutztown Univ. of Pennsylvania - *Late Spring Frost Damage Across The Southeast United States.* Discussant: **Charles E. Konrad, II**, UNC at Chapel Hill.

Session 10 - Southern Culture

Monday 10:15 am - 12:15 pm - Polo D

Chair: **Margaret M. Gripshover**, Univ. Tennessee.

Michael E. Crutcher, Univ. Kentucky. *Your South or Mine: Contemporary Expressions of Southern Black Identity*

Discussant: **John Strait**, Louisiana Tech Univ.

Futamura, Taro, Univ. Kentucky. *What is Our "Local Food"? Localism in Kentucky's Local Food Movement.* Discussant: **Stephen Birdsall**, UNC at Chapel Hill.

Craig R. Laing, Univ. Tennessee at Chattanooga. *Meth in the Mountains: Methamphetamine's Growth in Appalachia.* Discussant: **Thomas L. Bell**, Univ. Tennessee.

Margaret M. Gripshover, Univ. Tennessee. *The Tale of the Dragon: How US 129 Went to Wheelie Hell.* Discussant: **Craig R. Laing**, Univ. Tennessee at Chattanooga.

Session 11 - Education and Information Technology

Monday 10:15 am - 12:15 pm - Polo E

Chair: **Barney Warf**, Florida State Univ.

David J. Cowen, Univ. South Carolina - *A Glimpse at the Future of South Carolina: A Geographic Perspective on Demographic and Economic Trends and Forecasts.* Discussant: **Katherine Hankins**, Univ. Georgia.

Thomas M. Ludden and Barbara B. John, UNC at Charlotte - *Effect of Neighborhood Schools on Housing Values in Charlotte, NC.* Discussant: **Jennifer Speights-Binet**, Univ. Houston, Clear Lake.

Raymond K. Oldakowski, Jacksonville Univ. - *Active Learning Exercises to Improve Place Awareness.* Discussant: **Barney Warf**, Florida State Univ.

Barney Warf, Florida State Univ. - *Political Economy of the Palm Beach County Biotechnology Research Park.* Discussant: **David Cowen**, Univ. South Carolina.

Session 12 - Panel Session: Stand Alone Geographers Affinity Group (SAGE)

Monday 10:15 am - 12:15 pm - Polo F

Organizers: **Helen Ruth Aspaas, Tom Howard**, Virginia Commonwealth Univ. and Armstrong College.

Moderator: **Tom Howard**, Armstrong College.

Panelists:

Harlow Head, Barton College

Ann Oberhauser, West Virginia University

Clifton Pannell, University of Georgia

Donald Zeigler, Old Dominion University